

Residential Infill Development

with Potential for Land Assembly



Address	16 Aubrey Avenue Richmond Hill, ON L4E 2T6
Size	735 ft. x 315 ft.
Zoning	Residential Urban (RU)
Official Plan	Neighbourhoods

The RE/MAX® Realtron Land Services Group presents an exclusive investment opportunity in Richmond Hill, Ontario.

16 Aubrey Avenue is a parcel of land located in the Elm Grove/Maple Grove/

Aubrey Avenue **Infill Study area**. The study, which emphasizes improved pedestrian connections, residential infill development, and retaining natural features, anticipates rapid development in the near future, as evidenced by numerous residential developments nearby, including Maple Park on 4 and 6 Aubrey Avenue.

The neighbourhood proposes new residential subdivision and community facilities to the north, single family units to the west, a mix of single family residential and commercial to the south and existing commercial to the east on Yonge Street. The commercial area at the intersection

of Yonge Street and King Road is expected to undergo major mixed-use redevelopment.



16 Aubrey Avenue is an opportunity to invest in the rapidly intensifying heart of Richmond Hill.

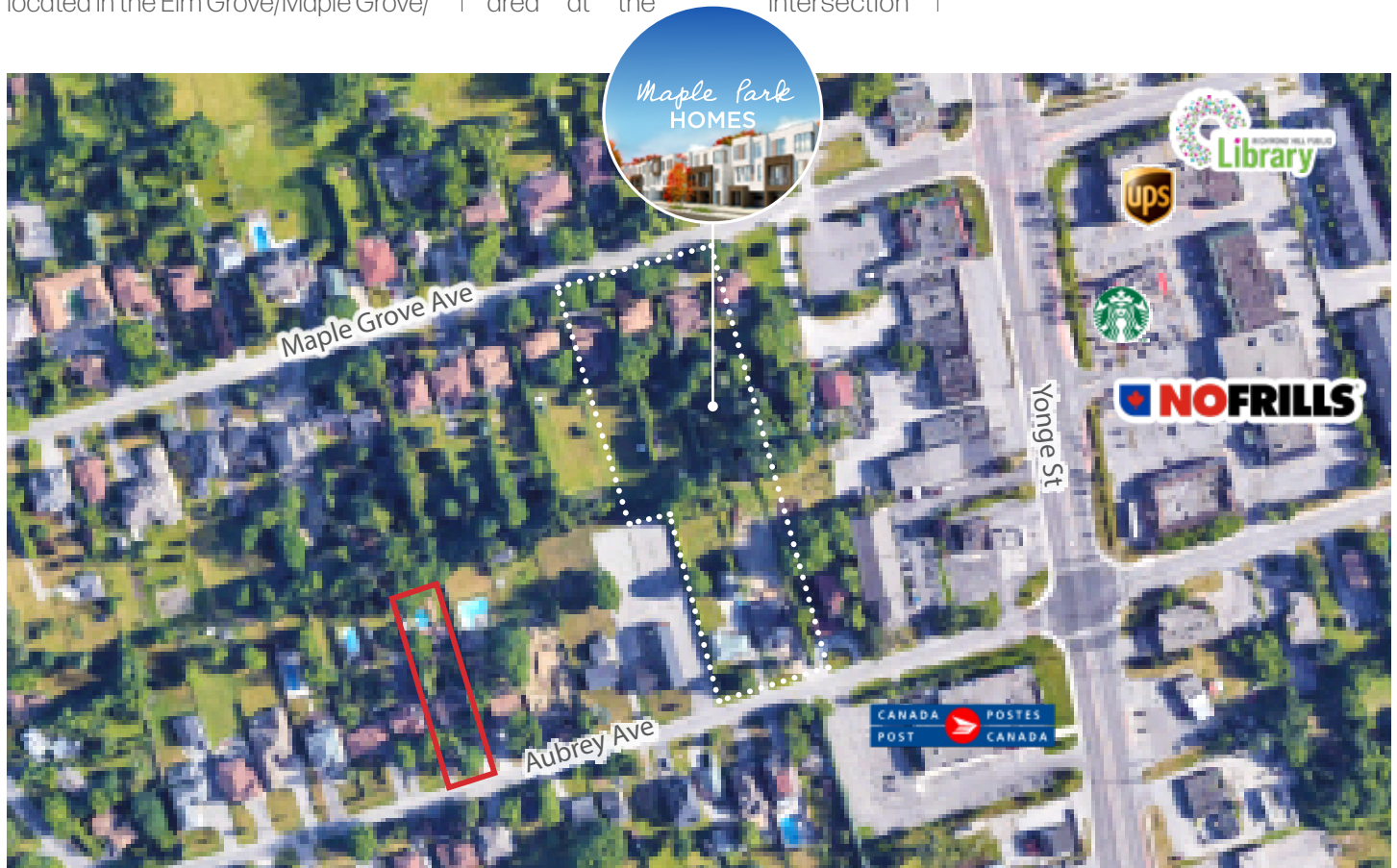

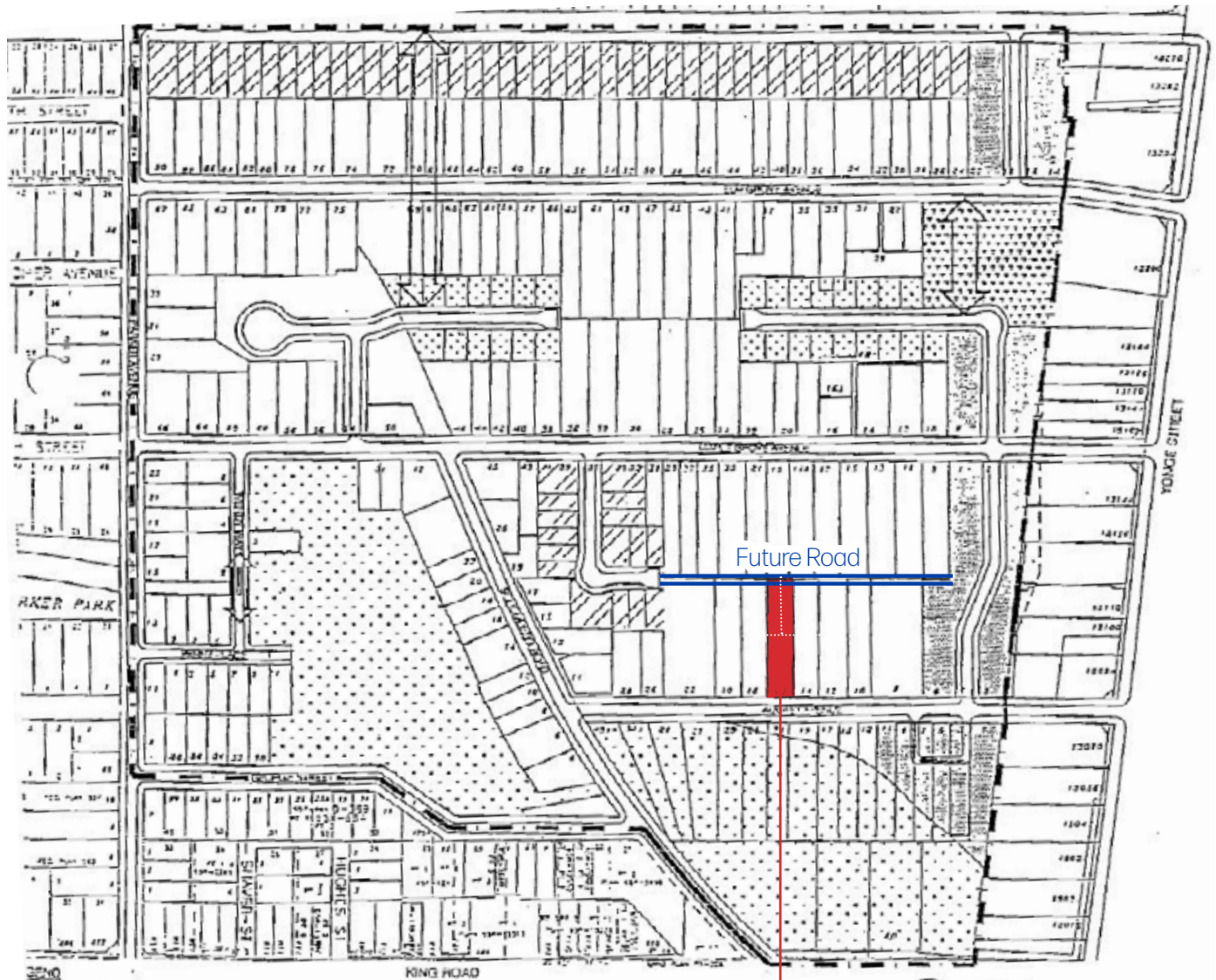

Future Road

16 Aubrey Avenue
 Two north lots, one south lot

Contact

Reza Esmaeili
 Broker of Record
 esmaeili.reza@gmail.com
 www.landservicesgroup.ca
 +1 (647) 962-7070



This disclaimer shall apply to RE/MAX® Realtron Brokerage and to all other divisions of the Corporation; to include all employees and independent contractors. The information set out herein, including, without limitation, any projections, images, opinions, assumptions and estimates obtained from third parties (the "Information") has not been verified by RE/MAX®, and RE/MAX® does not represent, warrant or guarantee the accuracy, correctness and completeness of the Information. RE/MAX® accept or assume any responsibility or liability, direct or consequential, for the Information or the recipient's reliance upon the Information. The recipient of the Information should take such steps as the recipient may deem necessary to verify the Information prior to placing any reliance upon the Information. The Information may change and any property described in the Information may be withdrawn from the market at any time without notice or obligation to the recipient from RE/MAX®. RE/MAX® and the RE/MAX® logo are the service marks of RE/MAX® Limited and/or its affiliated or related companies in other countries. All rights reserved.